

CITY OF WILLIAMSPORT, PA RESOLUTION

RESOLUTION # 9272

DATE 3-17-22

TITLE

RESOLUTION AUTHORIZING THE FILING OF A STATEWIDE LOCAL SHARE ASSESSMENT (LSLA) GRANT THROUGH THE COMMONWEALTH FINANCING AUTHORITY (CFA), AND DESIGNATING THE MAYOR AND THE CITY CONTROLLER AS THE OFFICIALS TO EXECUTE ALL DOCUMENTS AND AGREEMENTS BETWEEN THE CITY AND CFA.

Be it RESOLVED that the City of Williamsport of Lycoming County hereby request a Statewide Local Share Assessment grant of \$ 648,096 from the Commonwealth Financing Authority to be used for the Shaw Place Park Improvements.

Be it FURTHER RESOLVED that the City of Williamsport does hereby designate Derek Slaughter, Mayor, and Margaret Woodring, City Controller, as the officials to execute all documents and agreements between the City of Williamsport and the Commonwealth Financing Authority to facilitate and assist in obtaining the requested grant.

Approved

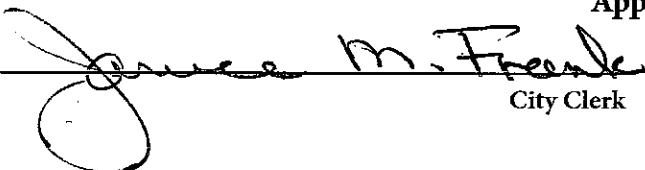

City Clerk

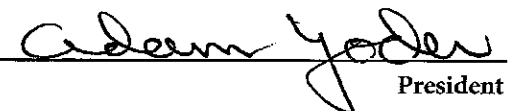

President

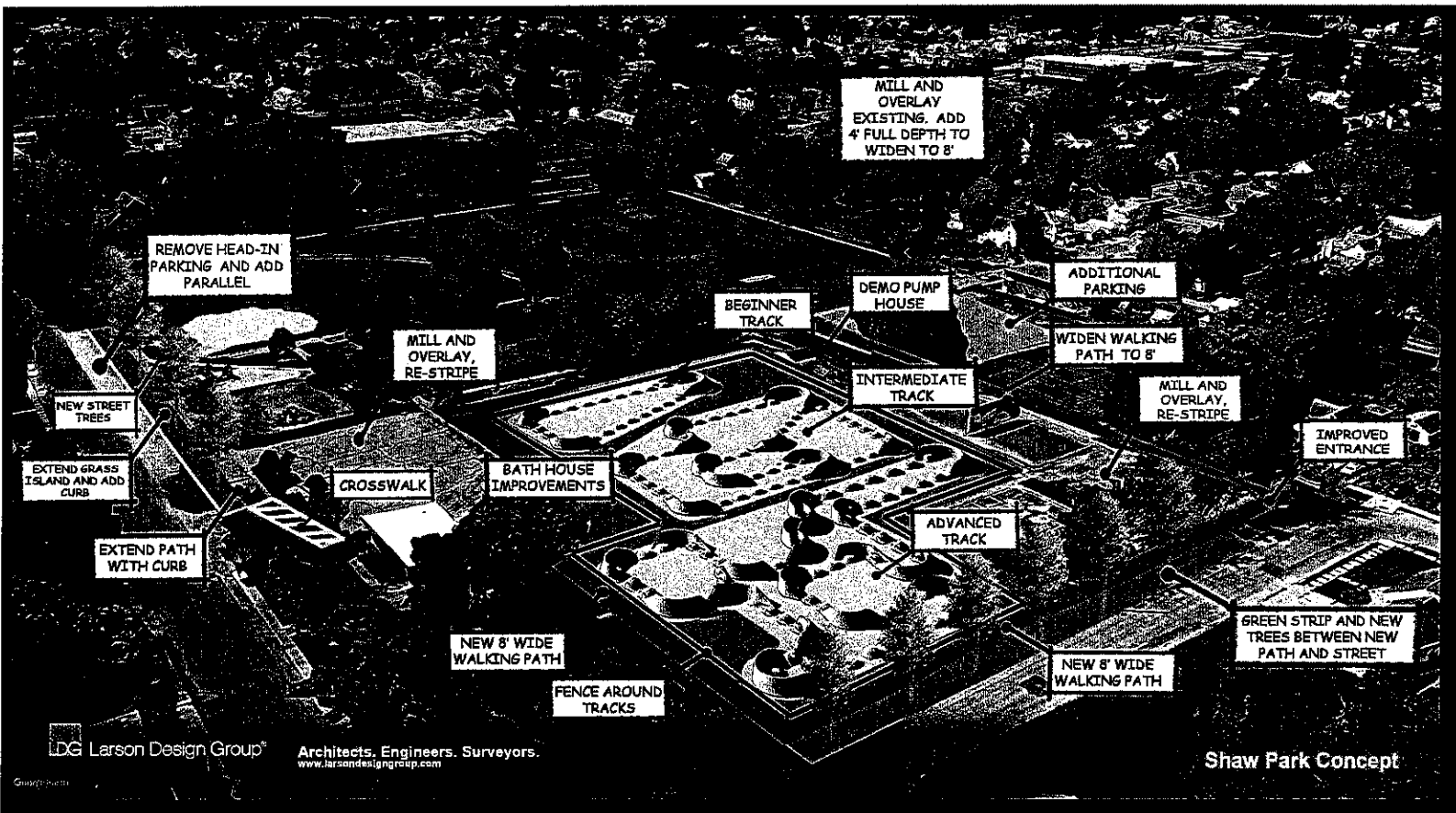

LDG Larson Design Group

Architects, Engineers, Surveyors.

www.larsondesigngroup.com

Shaw Park Concept

EXHIBIT 1. PROJECT DESCRIPTION

A. PROJECT DESCRIPTION

The City of Williamsport is requesting \$648,096 in Statewide Local Share Account (SLSA) funds to provide a number of improvements at the Shaw Place Park. The improvements include:

- Installation of a pumptrack that will include a beginner track, intermediate track, advanced track
- Demolition of existing pump house
- Bathhouse improvements
- Widen 4'-6' wide walking path
- New 8' wide walking path
- Fencing around pumptrack
- Parking Lot upgrades (basketball court and main parking lot)
- Tennis court improvements
- New street trees
- Erosion and sedimentation control
- Drainage improvements

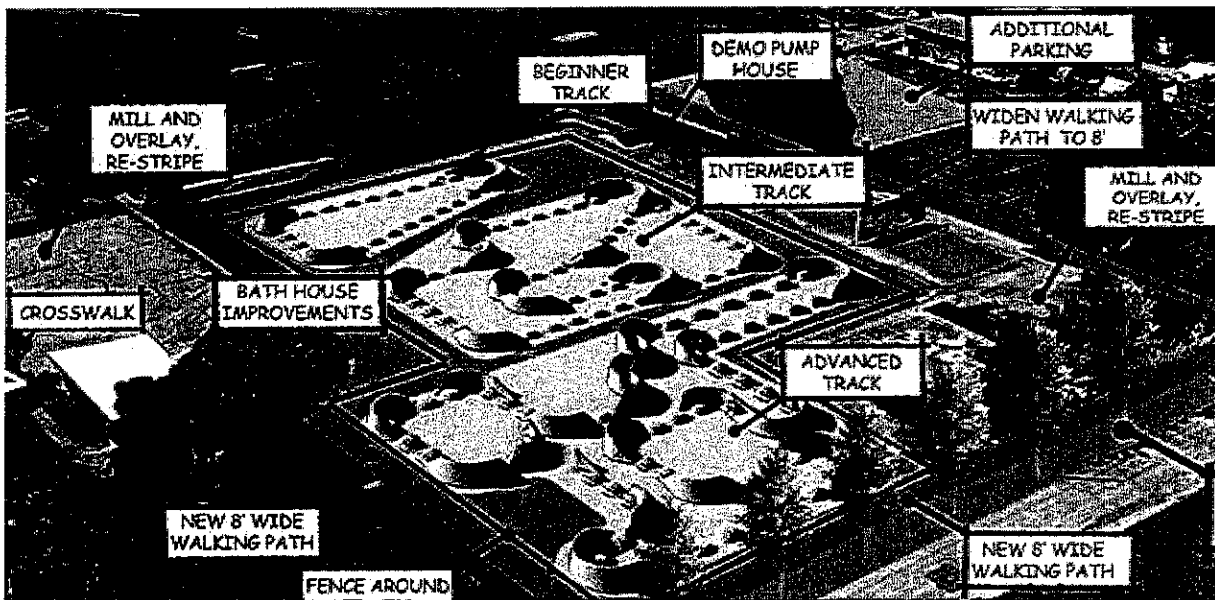

Figure 1. Shaw Place Park Improvements

B. PROJECT LOCATION

The project is located in the City of Williamsport, a 3rd class city located in Lycoming County. It serves as the county seat and is the principal city of the Williamsport Metropolitan Statistical Area. The population in the City of Williamsport has been declining, in 2010 there were 29,381 persons residing in Williamsport, by 2020 the population declined to 27,754. The City has a diverse population, and 20.2% of this population is under the age of 18. Over twenty-five percent of the population lives below poverty level.

Shaw Place Park

The project is located at Shaw Place Park, an 8.1-acre park located in the northeastern corner of the City and bordered by Sherman Street, Almond Street, Shaw Place and Ellinger Street. Due to its size Shaw Place draws users from throughout the City in addition to the surrounding neighborhood. The neighborhood around Shaw Place can be characterized as a stable, largely owner-occupied residential neighborhood.

Site Advantages: Shaw Place Park offers ample space to easily accommodate a multitude of active and passive recreational uses. The park’s swimming pool, courts, fields, and open space offer potential for diverse recreational experiences. Shaw Place’s generous size also provides space where neighborhood residents can walk for fitness and recreation. The park has good public access on Sherman Street and neighborhood access from smaller side streets and alleys to the north and west.

City of Williamsport Demographic and Socioeconomic Information	
POPULATION TRENDS	
Population 2010	29,381
Population 2020	27,754
RACE AND HISPANIC ORIGIN	
White Alone	80.1%
Black or African American Alone	14.3%
American Indian and Alaska Native Alone	.5%
Asian Alone	1.2%
Native Hawaiian and Other Pacific Islander Alone	0%
Two or More Race	3.5%
Hispanic or Latino Alone	2.4%
AGE	
% Under 18 Years	20.2%
% over 65	13.3%
INCOME AND POVERTY	
Median Household Income	\$39,990
Persons in Poverty	25.4%

C. PLANNING CONSISTENCY

Williamsport Parks Master Plan, 2006

In 2006, the SEDA Council of Governments Community Resource Center prepared the Williamsport Parks Master Plan which evaluated opportunities for improvement in the City’s neighborhood parks which included: Newberry Park, Lose School Park, Flanigan Park, Young’s Woods Park and Shaw Place Park. The City of Williamsport Parks Master Planning Project undertook an aggressive approach in determining public opinion of the current status and future opportunities for each park. The process included five study committee meetings; five focus group interviews with residents of each park neighborhood; over one thousand city-wide random sample telephone surveys to explore public opinions and preferences relevant to parks; 10-12 intercept interviews with park users at each location, and a design workshop with neighborhood residents.

Shaw Place Park offers ample space to easily accommodate a multitude of active and passive recreational uses. The park's swimming pool, courts, fields, and open space offer potential for diverse recreational experiences. Shaw Place's generous size also provides space where neighborhood residents can walk for fitness and recreation. The park has good public access on Sherman Street and neighborhood access from smaller side streets and alleys to the north and west.

The master plan developed for Shaw Place emphasized the need to enhance the park's existing features and then add amenities to further strengthen the park's Citywide use.

Improvements to the park should provide a variety of activities for multiple age groups.

The pumptrack will be an exciting addition to this park and will encourage residents of all ages to participate in outdoor activity. The wider walking trail will also encourage residents to get outdoors and walk.

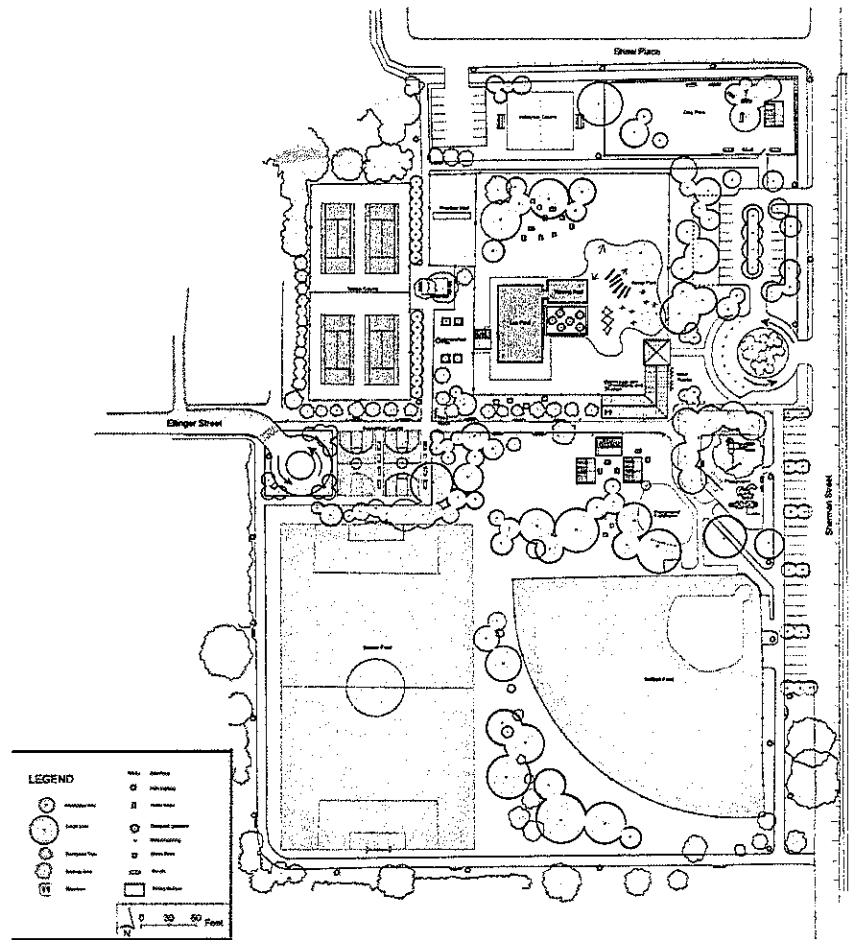

Figure 2. Shaw Place Park Master Plan

D. ECONOMIC AND COMMUNITY IMPACT

According to the Williamsport Master Plan, “research has shown that cities can successfully use parks for community revitalization, public engagement, economic development, to create safer neighborhoods, for green infrastructure, to help children learn, to improve public health, for arts and cultural programs, to promote tourism, and for smart growth”.

The population in the City of Williamsport has been declining for the past few decades. The City has been diligently working on improving the economic conditions through transportation improvements, investing in partnerships, and creating investments to incentivize development. Investing in recreational improvements will improve the attractiveness factor of the City and will greatly aid the City and its industries' efforts to attract workforce to reside in the City.

Health Benefits and Quality of Life:

The City's parks and recreation areas play a key role in improving the overall health of its residents. Ensuring everyone has the ability to become physically active will help reduce health risk factors and improve mental health. The proposed improvements will ensure that residents of all abilities, ages, ethnicities, and socio-economic backgrounds can participate in daily physical activity. The improvements can:

- Enable people of all ages to stay active
- Encourage family play and activity
- Foster social development as a place for meeting other residents, giving all the chance to interact with each other in this highly active common play area
- Encourage participants to be physical active which will aid in maintaining a healthy body weight and increase physical strength
- Encourage children to trade indoor time for outdoor time and transition children from a sedentary to active lifestyle.

COLOR-CODED MAP

N/A – One Location

PROJECT SCHEDULE

Project Task	Start Date	End Date
Final Design	September 2022	December 2022
Preparation of Plans/Spec; Bid Documents	December 2022	January 2023
Bidding/Award	February 2023	March 2023
Construction	April 2023	April 2024